

Washing machine – Professional

proLine W220 / W300



This is the Schulthess proLine The Game Changer. With this professional machine you save time, do more laundry, cut costs and protect the environment at the same time. The figures prove it: The proLine handles 500 more laundry loads every year. The 24 and 33-kilo machines are perfectly suited to the needs of care institutions, hospitals and facility management companies with their wetClean programmes.

Models



proLine W220
Stone
 4206.1



proLine W300
Stone
 4207.1

Features

- Industrial washing machine for gentle fabric care
- Control with 24 standard programmes and 24 freely programmable positions
- Intuitive operation with 4.3" colour display
- High spin speed for minimum residual moisture (up to 48 %)
- Stainless steel drum and washing liquor tank for efficient washing and rinsing processes
- Cold, hot or soft water connection (selectable on site)
- Language selection button with over 20 different languages
- Start delay with calendar function
- Swiss made and designed for over 30'000 operating hours

Options

- WLAN interface for programme and software updates
- Connection for 8 liquid detergent dosing pumps
- Standard machine plinth
- Mains blocking set (load shedding/current peak)

Technical data Washing machine proLine

Brand names		Schulthess	Schulthess
Model name		proLine W220	proLine W300
Product number		4206.1	4207.1
Features			
Drum volume	l	220	300
Load (1:9)	kg	24	33
Load (1:10)	kg	22	30
Drum opening	mm	800	800
Drum depth	mm	437	597
Spin speed	U/min	1000	950
g-factor		447	404
Residual moisture	%	~ 48	~ 48
Electrical installation			
Supply voltage	V	400 3N~ / 50 Hz	400 3N~ / 50 Hz
Connected load	kW	20	26
Electric heating	kW	17.4	22.5
Drive	kW	2.2	3
Protection	A	32	50
Sanitary installation			
Water connection	Ø "	3/4	3/4
Drain valve diameter	Ø "	3	3
Water pressure on-site	MPa	0.15 – 1.0	0.15 – 1.0
Cold water (hard) inflow	l/min	> 65	> 65
Hot water inflow (max. 70°C)	l/min	> 30	> 30
Drainage rate (drain valve)	l/min	260	260
Dimmension			
Width	mm	1050	1050
Height	mm	1555	1555
Height incl. base	mm	1815	1815
Bottom edge of door incl. base	mm	805	805
Depth (door closed)	mm	970	1150
Door opening diameter	mm	450	450
Weight (empty)	kg	455	545
Additional appliance data			
Name and address of provider		Schulthess Maschinen AG, CH-6330 Cham ZG	Schulthess Maschinen AG, CH-6330 Cham ZG

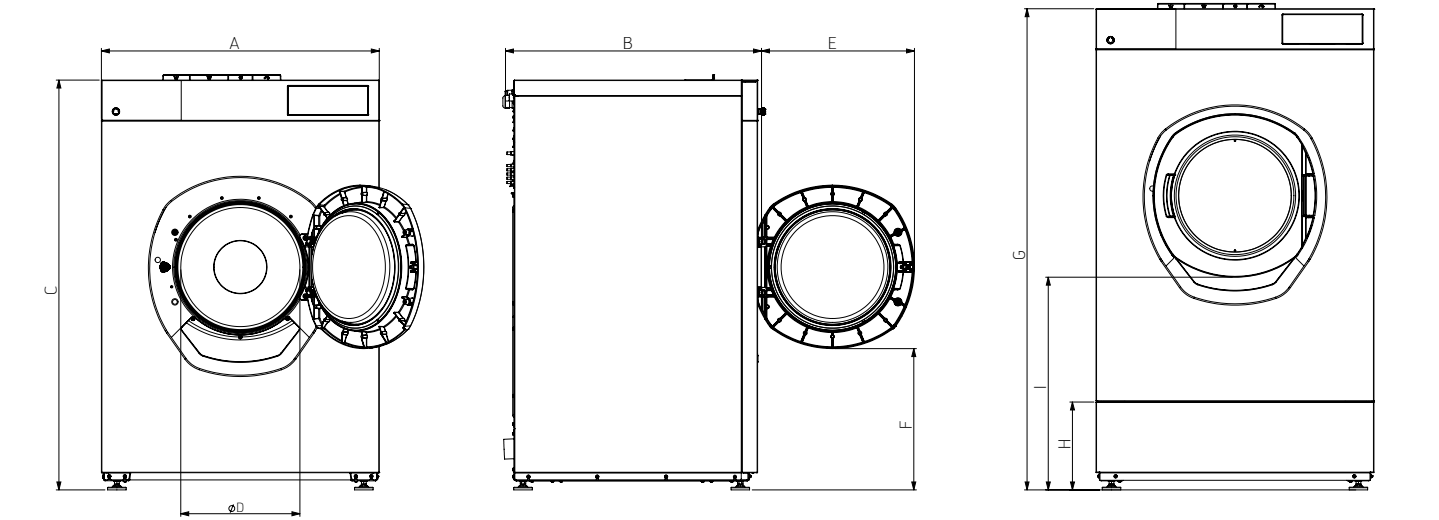

	A	B	C	D	E	F	G	H	I	Weight (kg)
W220	1050	970	1555	450	580	535	1815	335	805	455
W300	1050	1150	1555	450	580	535	1815	335	805	545

FEA The standardised product declaration complies with the guidelines issued by the FEA Swiss Association of Household and Commercial Appliances in cooperation with consumer organisations. The product declaration is based on the standards of the IEC International Electrotechnical Commission (Technical Commission TC 59).